



**RETAIL, RESTAURANT, OFFICE**



Location: End of Building C (**Unit #C-5**)  
 2100 Kanoelehua Avenue  
 Hilo, Hawaii 96720

TMK: (3) 2-2-40

Size: **Build-to-Suit** end-cap of building up to 15,000 square feet

Zoning: CN-10, Neighborhood Commercial District

Minimum Rent: \$2.00 per square foot per month  
 Operating Expenses: \$0.45 per square foot per month (Budget for 2009)  
 Real Property Tax: \$4,944.72 every 6 months (actual for FY 2008-9)

Merchants Include: McDonalds      Taco Bell      Subway  
 Baskin Robbins      Sack-N-Save      H&R Block  
 Checker Auto      Fantastic Sams      Windward Pharmacy  
 Rent-A-Center      Beltone Hearing

Contact: Aron Chock  
 Phone: (808) 254-1234 / Fax: (808) 254-8899  
 Email: aron.intco@gmail.com  
 Website: www.puainakocenter.com

*The information contained herein comes from sources deemed reliable, but no warranties or guarantees as to the accuracy of the information should be construed. All information is subject to change at any time without notice. All tenants are subject to Landlord's approval.*

# Building "C"

Total Area: 14,822 square feet

Ceiling Height: 14 feet

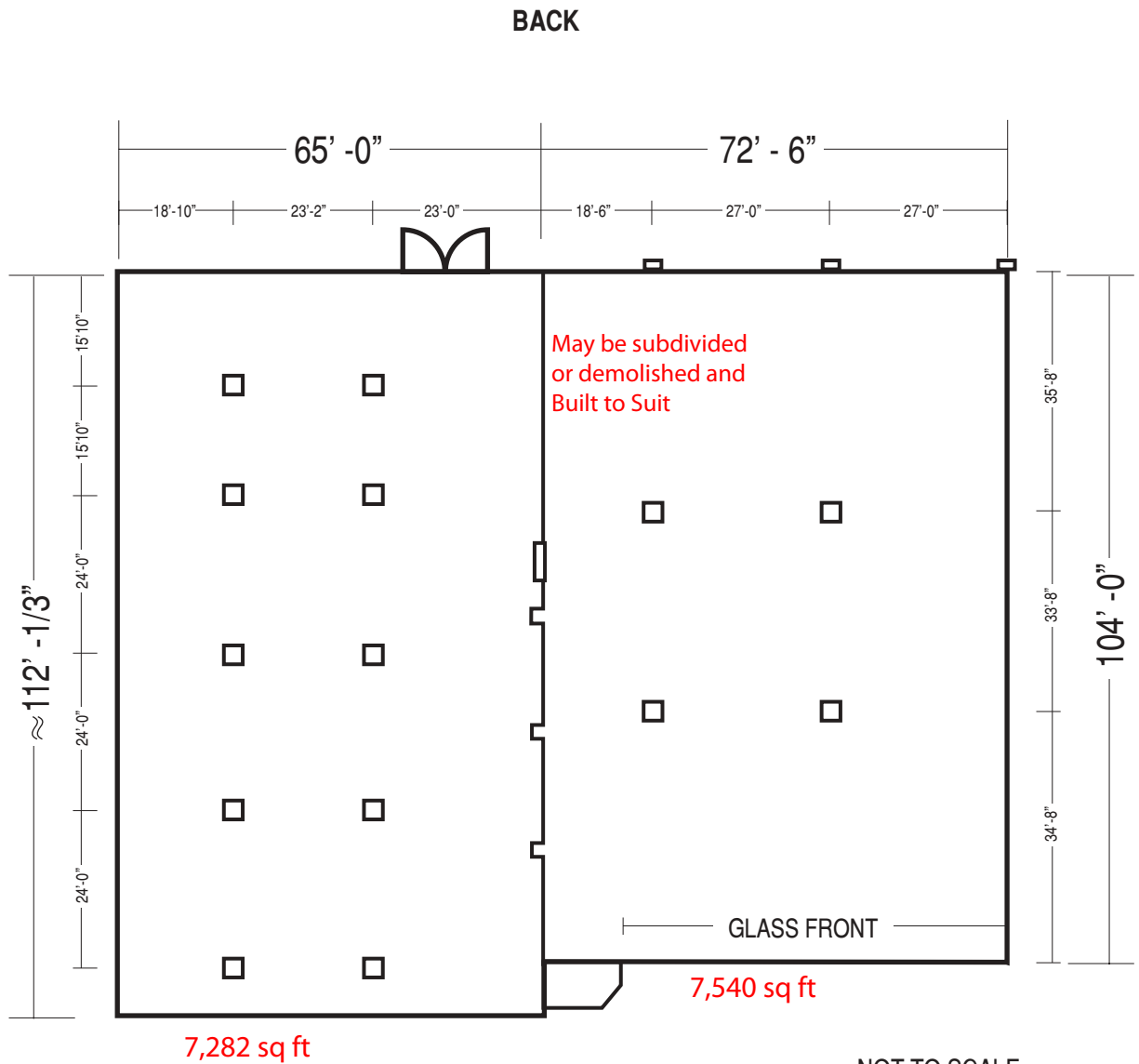

**PUAINAKO**  
CENTER

Intco Investments/PTC Partners

44-224 Malae Place / Kaneohe, Hawaii 96744 • Tel: 808.254.1234 / Fax: 808.254.8899

email: aron-intco@hawaii.rr.com • Online at <http://www.puainakocenter.com>



# PUAINAKO CENTER

2100 Kanoelehua Ave.  
Hilo Hawaii 96720

Ph. (808)254-1234  
Fax (808)254-8899  
Email: aron.intco@gmail.com  
www.puainakocenter.com

## SITE PLAN

Unit	Unit	Unit	Unit
<b>C-5 BUILD TO SUIT</b>	<b>B-5</b> Beltone Hearing Ctr.	<b>B-14</b> Rent-A-Center	<b>A-4</b> Ling's Chopsuey
<b>C-4</b> Checker Auto Parts	<b>B-6</b> Nail Tech	<b>B-15</b> Rent-A-Center	<b>A-5</b> Ling's Chopsuey
<b>C-3</b> Checker Auto Parts	<b>B-7</b> H&R Block	<b>B-16</b> Encore	<b>A-6</b> 5-Spice
<b>C-2</b> Checker Auto Parts	<b>B-8</b> Fantastic Sam's	<b>B-17</b> Encore	<b>A-7</b> Alpha Video
<b>C-1</b> Checker Auto Parts	<b>B-9</b> Century 21	<b>B-18</b> Encore	<b>A-8</b> Alpha Video
<b>B-1</b> Hawaii Nat. Bank	<b>B-10</b> Century 21	<b>B-19</b> Encore	<b>A-9</b> Alpha Video
<b>B-2</b> Hawaii Nat. Bank	<b>B-11</b> Pizza Hawaii & Deli	<b>A-1</b> Sack-N-Save	
<b>B-3</b> Windward Pharmacy	<b>B-12 AVAILABLE</b>	<b>A-2</b> Sack-N-Save	
<b>B-4</b> Hilo Chiropractor	<b>B-13</b> Rent-A-Center	<b>A-3</b> Ling's Chopsuey	

